

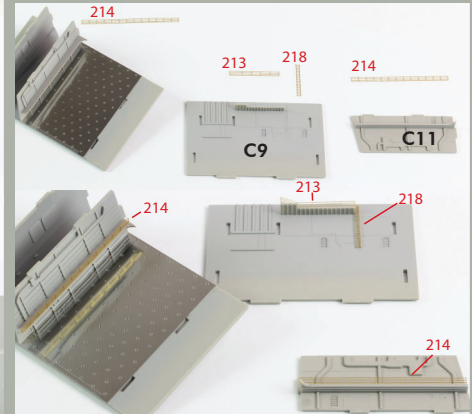

# 35016F1 1/350 USS San Antonio Class LPD Detail up Set

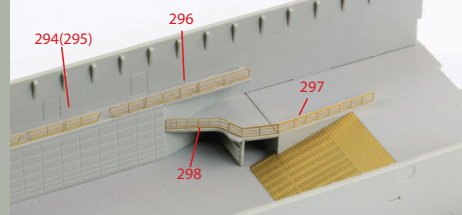
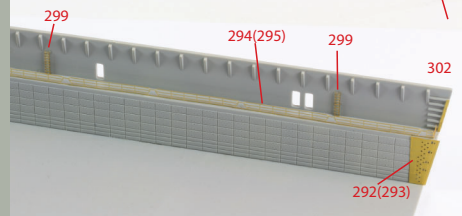
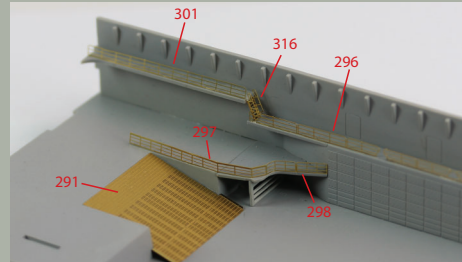
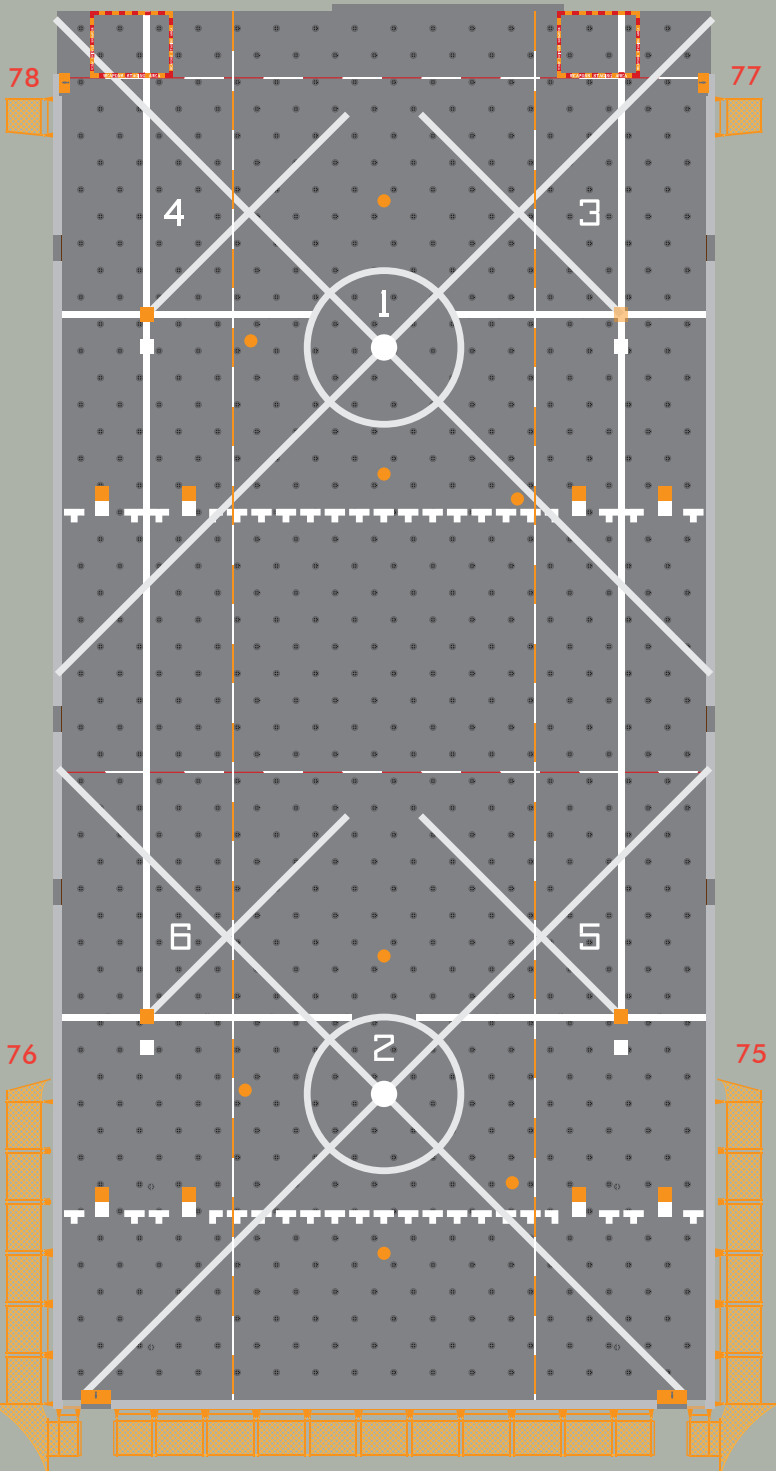

### < Contents >

- 1. Scribed Brass : 54 Pcs.
- 2. Photo Etching : 4 Sheets
- 3. Resin Parts : 15 Pcs.
- 4. Dry Transfer : 1 Sheet  
(For LPD-17/18/19/20/21/22/23/24/25)

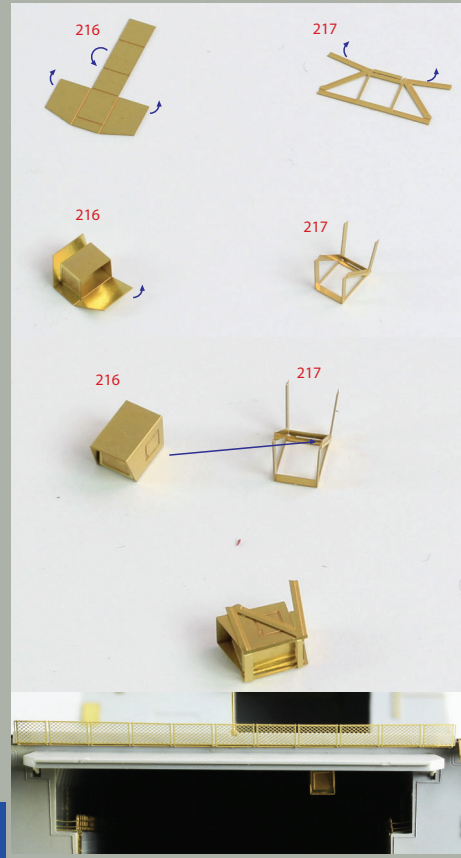

### < Scribed Brass Parts : 54 Pcs. >

- 01. Mk-46 30mm Gun : 2pcs
- 02. Cal50 Barrel : 6pcs
- 03. Cal50 Base : 2pcs
- 04. Dom antenna : 4pcs
- 05. 35Ft Whip Antenna : 3pcs
- 06. 18Ft Whip Antenna : 2pcs
- 07. Antenna base : 2pcs
- 08. Antenna base2 : 2pcs
- 09. Top mast : 1pc
- 10. Capstan 1 : 2pcs
- 11. Capstan 2 : 2pcs
- 12. Bitt : 20pcs
- 13. Crane Axis 1 : 1pc
- 14. Crane Axis 2 : 1pc
- 15. Crane Axis 3 : 1pc
- 16. Refuel Tower Axis : 1pc
- 17. Staff 1 : 1pc
- 18. Staff 2 : 1pc

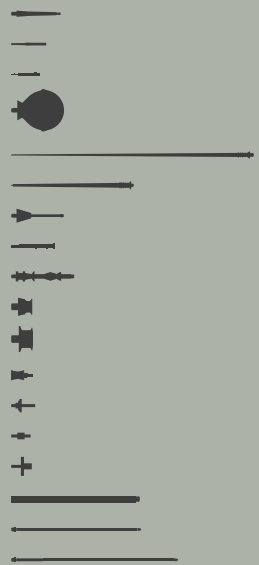

### < Veteran Model Resin Parts : 15Pcs. >



For better information or corrections, we update this manual on our website.  
Pontomodel makes every effort to see to it that our customers are satisfied. If you have product suggestions or if there is a particular product of dry transfer you would like to suggest we carry, please feel free to contact us.